

GENERAL INFORMATION

The pneumatic crimp tool is applied to cold crimp connection of round contacts and round wires. The four indenters crimp at the same time, 4 impressions in each direction, and the maximum crimping length (3mm) of the W1Q crimp tool is achieved. Due to the high precision of the tool itself and the increased cylinder output pressure, the W1Q achieves the most complete and reliable crimping state.

Selector No.	Indenter Working Diameter mm/INCH	
	A (GO)	B (NO GO)
1	0.33/0.013	0.46/0.018
2	0.41/0.016	0.54/0.021
3	0.48/0.019	0.61/0.024
4	0.56/0.022	0.69/0.027
5	0.66/0.026	0.79/0.031
6	0.76/0.030	0.89/0.035
7	0.86/0.034	0.99/0.039
8	0.99/0.039	1.12/0.044

WORKING PRINCIPLES

1. The crimp tool adopts curve propulsion mechanism, its applied force transfers through four curves in the head cavity of the right plier handle to the four indenters. The four indenters do the centripetal linear motion, which makes its front-end teeth crimp the contact to complete the crimping process. The cycle controlled precision ratchet assures the consistency of impression and the crimping quality of wires and contacts.
2. Ratchet and rack match up the self-locking mechanism ensure the accordance of each crimping. Lack of air pressure or short of air supporting time will cause the tool not be able to crimp properly, the press mould can not return to the correct place because of the self-locking mechanism. By adjusting air pressure or increase the air supporting time, the press mould will arrive to the correct place, the problem can be solved.
3. This crimp tool has eight working selections. Firstly, take out the locking pin, lift up the select knob and rotate, make sure the pointer align with the desired selection, then put down the select knob, start crimping the contacts.
4. This crimp tool uses an external foot pedal to control the air supply.

CAUTIONS

1. Due to the increase of cylinder output pressure, the tool can crimp small soft steel or stainless steel wire and sleeve. Do not crimp any hard steel material or not matched size contacts, please contact us if the tool get stuck by improper use.
2. Working air pressure: 80-120 P.S.I. Max air pressure: 120P.S.I (5.5-8.3BAR)

CRIMP PARAMETERS

1. Shape of Indenter

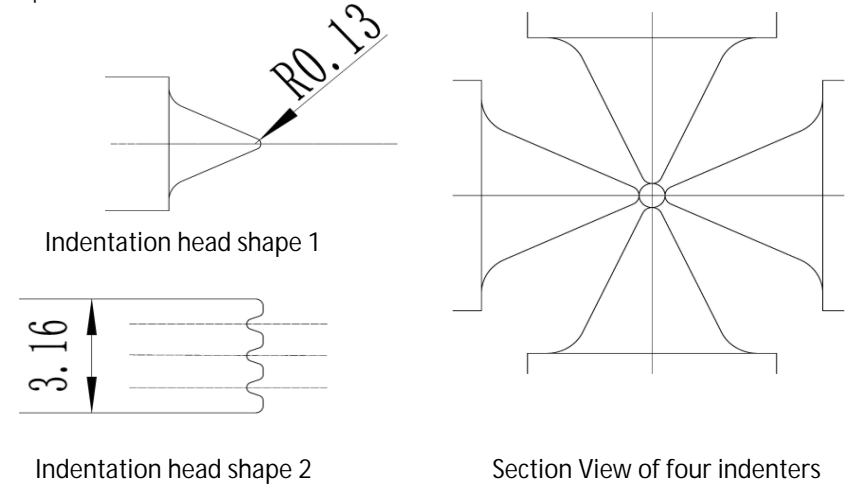

2. Axial Positioner: This tool matches all the positioners which are suitable for M22520/2-01 hand crimping tool (need purchase separately). You can also customize axial positioners for your products.

3. Crimping Instruction: firstly insert the contact and wire, supply the air by foot treadle or manual button, release the foot treadle or manual button after the crimping completed. Take out the contact when the indenter back to the original position.

